

Mo/Rh kV measurements

6 cm

Place the detector along the X-ray tube axis with the MAM sensor centered 6 cm from the edge (see illustrations).

Place this 2 mm Al filter on the compression paddle, centered above the MAM sensor. Position the paddle as high as possible.

Recommended generator setting > **100 mAs**.

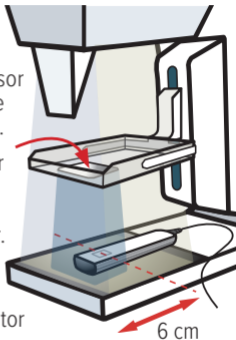

Table
edge
0 cm