

RaySafe dental measurements

PANORAMIC

1a

1b

2

3

4

5a

Gafchromic film

5b

Fluorescent film

6

7

8

ON

9

→ (Solo) SENSOR MENU
DENT low
DENT high

→ (Xi) SENSOR MENU
R/F low
R/F high

10

Note: If "high signal" response after exposure, select DENT- or R/F-high.

INTRA

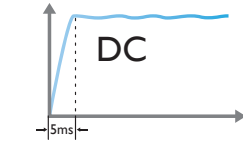
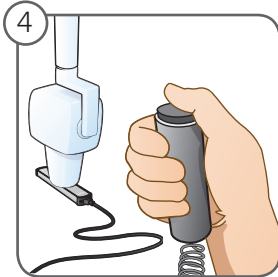
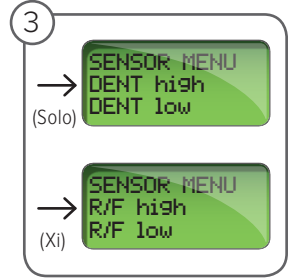
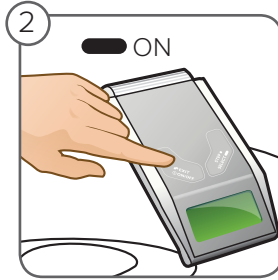
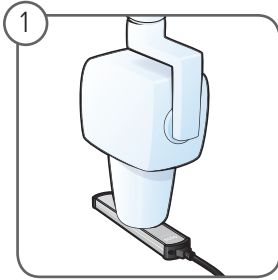

→ kVp Delay: 5ms
Trig Delay: 0
Calc. Delay: 0.5

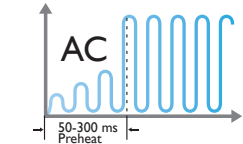

→ kVp Delay: 50-300ms
Trig Delay: 0
Calc. Delay: 0.5
Trig Level: 25, 50 or 75%

Note: the Set kVp delay or trig level depending on type of machine and waveform.

CBCT

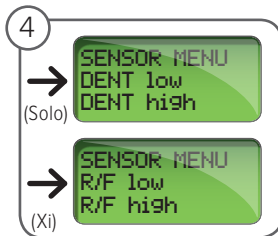
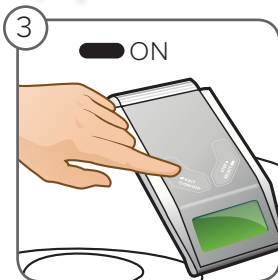
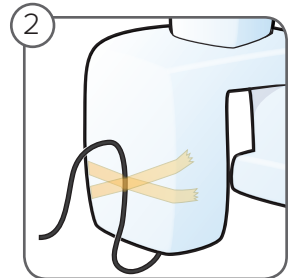
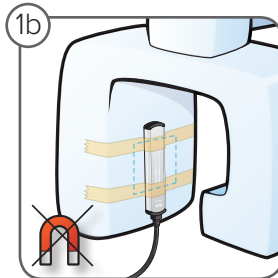
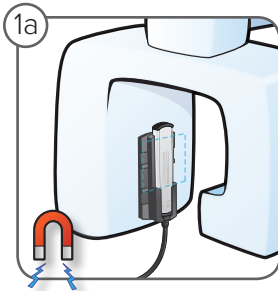

Note: If "high signal" response after exposure, select DENT- or R/F-high.

